



FINDEISEN
NÜRNBERG



SPEEDFORCE

Limited Edition

OPERATING INSTRUCTIONS

FINDEISEN - Made in Nürnberg

Congratulations on the purchase of your FINDEISEN watch, share the personal moments you experience with your FINDEISEN SpeedForce with #speedforce or #daretobedifferent on: @findeisen_watches_official

Since the company was founded in 2017, we have focused on high-quality wristwatches with a mechanical drive. The name FINDEISEN stands for precision, quality and durability.

All FINDEISEN watches are designed, developed and assembled in the heart of Nuremberg's old town. Before your watch has left our premises, it has been worked pretty hard to guarantee you a timepiece that you will enjoy for a long time. We are so reassured by this fact that we offer a 3-year guarantee on every FINDEISEN watch.

About

The name:

Findeisen is an old Saxon family name originating in the Ore Mountains around the small town of Zschopau. The ancestors of the Findeisen family lived in this area as early as the late 18th century. In the Middle Ages, Findeisen was a common name for journeymen blacksmiths. Even today, the name is most commonly found in the so-called Christmas country.

In the 1960s, Max Findeisen (1907 - 1973) redesigned the dial of a wristwatch with Findeisen lettering, creating the basis for an idea that would remain dormant for several decades until it was realized. It was not until around 50 years later that Findeisen's great-grandson Martin Zettl took up the idea of a watch brand with the name FINDEISEN again.

Today you can wear a realization of this idea on your wrist!
Have fun with your FINDEISEN!

Operating instructions

Winding the watch (crown position 0)

The SpeedForce is equipped with a non-screw-down crown (crown position 0). Wind the movement by turning the crown clockwise. As a rule, around 40 turns are sufficient. If the watch is worn every day, the automatic mechanism will continue to wind the watch under normal conditions. The power reserve of up to 50 hours allows you to take the watch off overnight, for example, without having to wind it up again.

Quick correction of the date (crown position 1)

Pull the crown into position 1 and turn it clockwise until the current date is displayed in the date window. To avoid damaging the date adjustment mechanism, please do not operate the quick date adjustment between 8.00 p.m. and 2.00 a.m.

Time setting (crown position 2)

The movement is stopped in crown position 2. This allows you to set the watch to the exact second. To ensure that the date switches at midnight instead of midday, turn the hands forwards until the date switches. Another indicator for ensuring the correct time for the date is provided by the 24-hour display at 3 o'clock. Then set the time. We recommend turning the hand past the desired minute marker and setting it on the way back. The movement is set in motion again as soon as you leave crown position 2.



The 24-hour display at 3 o'clock always shows you whether it is morning or afternoon, in line with the time.

IMPORTANT: Please push the crown carefully back into the case after setting to avoid problems with water resistance. Please note that the manufacturer's guarantee cannot be granted for operating errors.

Additional functions of the SpeedForce L.E.

The SpeedForce Chronograph is equipped with a tachymeter scale on the bezel, which is firmly attached to the case. This allows you to measure the speed of an object using the stop-seconds hand (red).

Example for measuring the speed of a vehicle: Start the chronograph (pusher 1) when starting the vehicle and measure the time in which the vehicle travels 1 kilometer. The speed can now be read off via the red stop-second hand on the tachymeter scale.

Whenever the stop-seconds hand has circled the dial once, the minute stop hand (black or blue with white tip) counts up to 60 minutes.

The counter at 6 o'clock counts up to 12 full hours.

Use pusher 1 to stop the measuring or stopwatch process and pusher 2 to reset the chronograph to 0.0.

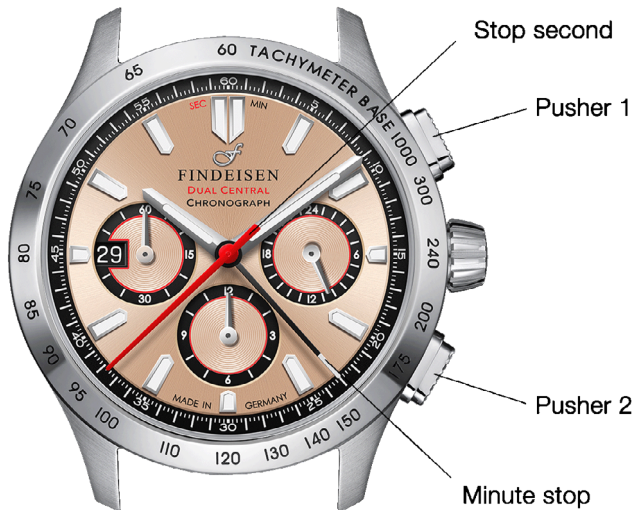

IMPORTANT: Keep sharp and acidic liquids away from the tachymeter bezel to avoid damaging the lettering. Only use soft microfiber cloths for cleaning. **Please note that the manufacturer's warranty cannot be granted for usage errors.**

Length adjustment of the steel bracelet

If you are not familiar with adjusting the length of your bracelet, please contact your FINDEISEN specialist retailer, we will also be happy to advise you by telephone.

You will achieve the best wearing comfort if both sides of the bracelet are the same length. If this is not possible, we recommend that the upper side (12 H) is longer. You do not need to remove the strap from the watch or the clasp to change the length.

1. loosen the screws on the side of the link to be removed or at the point where you wish to insert a link.
2. remove the loosened link or insert a new one.
3. apply a small drop (not more!) of the screw locking agent (Loctite 601) to the thread of the strap screw before screwing it in

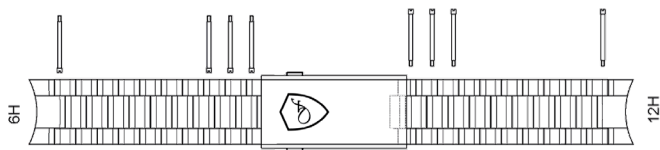

Length adjustment of the leather strap

1. detach the strap from the case. To do this, simply press the spring bar on the pin side against the case pin and remove the strap.
2. the clasp is a folding clasp in which the end of the bracelet is simply pushed in to the desired length with the folding mechanism unfolded.
3. when the desired length is reached, simply secure the folding mechanism again by turning it 180 degrees.

Please note: Only leather straps with flat and robust leather on the clasp side are suitable for the FINDEISEN folding clasp.

Operating the clasp

The SpeedForce is equipped with a fine adjustment clasp. This allows you, for example, to adjust the clasp quickly and without tools to the naturally increased wrist circumference in the evening hours.

To adjust the clasp length, remove the watch from your wrist and press the latch on the inside of the clasp to the 6 H side and simultaneously pull the strap to the desired position on the 12 H side. To reduce the circumference, simply push the strap on the 12 H side back into the clasp, while wearing it.

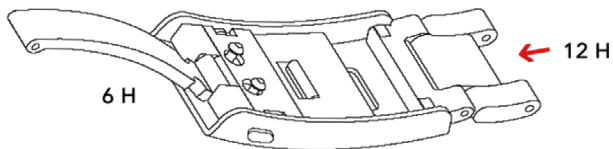
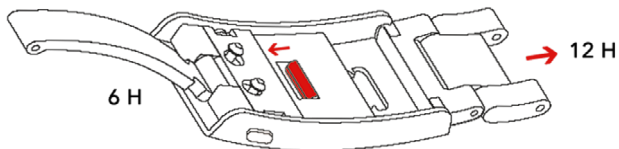

Operating the strap-quick-change-system

All SpeedForce straps are equipped with quick-release spring bars to make it easier for you to change straps.

Bracelet:

Press the pins together to release and remove the strap. To attach the steel strap, press the pins together and insert the strap between the lugs, then release the pins and make sure that both sides are engaged.

Leather strap:

Press the pin towards the inside of the strap and remove the strap. To attach the leather strap, insert the left pin into the lug-hole and press the pin inwards to engage it in the opposite lug-hole.

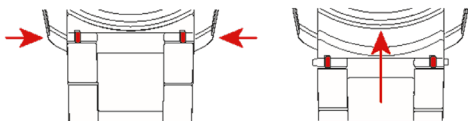

Bracelet

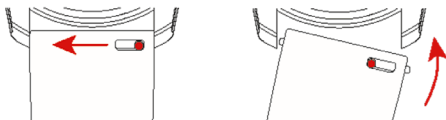

Leather strap

Technical features

Damasko manufacture movement C51-6 Top

- Self-winding, unidirectional
- 27 ruby jewels
- Silicon escape wheel
- 28,800 vibrations / h (4 Hz)
- Shockproof according to DIN 8308
- Anti-magnetic according to DIN 8309
- 50 hours power reserve
- Regulated in 5 positions
- Polished and blued screws
- Movement visually refined

Functions

- Hour, minute, small second
- Chronograph with
 - central second
 - Central minute
 - Small 12-hour counter
- Additional 24-hour display, analogous to the time
- Date with quick correction and quick setting

Case

- AISI 1.4404 stainless steel
- Brushed, polished bezel and pushers
- Crown not screwed in
- Sapphire crystal, 4-layer blue anti-reflective coating
- Case back screwed and brushed
- Bottom engraving blasted and polished
- Strap lug width 22 mm
- Case diameter 44 mm / 14.7 mm height
- Water-resistant to DIN 8310 up to 10 bar

The Limited Edition of the SpeedForce is limited to a total of 105 pieces.

Dial versions:

- Desert Oak x 35 (sand)
- SkyRunner x 35 (blue)
- Dark Guardian x 35 (black)

Care and instructions

The absolute water resistance of a watch cannot be guaranteed indefinitely. It can be impaired by the ageing of the seals or by unintentional shocks to the watch. We recommend that you rinse the watch with clear fresh water after immersion in seawater or after contact with chemicals and the like. Have the water resistance checked annually if you frequently wear the watch in or under water.

Protect your watch from unnecessary strain.

A clear statement on the rate accuracy can be made after approximately eight weeks of continuous use. During this time, the mechanism runs in, and the wearing habits, which are different for everyone, must also be taken into account. If you have any complaints, please check the daily wear over a longer period of time, but at least one week.

Like any precision instrument, a watch should be serviced regularly to ensure optimum performance. We recommend that you have your watch professionally checked every 3 to 4 years. Please note that this period may be shorter depending on the climate and conditions of use..

To ensure that your FINDEISEN watch remains a reliable companion for years to come, we recommend an overhaul after around five years to check the condition of the watch and replace worn or defective components if necessary. This involves completely dismantling the movement, cleaning it and applying new special oils to restore its precision. If necessary, we will fit your FINDEISEN with new seals - and then, of course, test the watch for water resistance.

The cost of the overhaul depends on the condition of the watch and the type of movement. To ensure that you are entitled to the 3-year guarantee, please always contact an authorized FINDEISEN dealer.

Information on water resistance

WATER RESISTANT GUIDE						
3 ATM (30m)	✓	✓	✗	✗	✗	✗
5 ATM (50m)	✓	✓	✓	✓	✗	✗
10 ATM (100m)	✓	✓	✓	✓	✓	✗
20 ATM (200m)	✓	✓	✓	✓	✓	✓



#DARETOBEDIFFERENT

Your contact to FINDEISEN

www.findeisen-watches.com

info@findeisen-uhren.com

+49 911 4771 7290

Geiersberg 7
90403 Nuremberg



FINDEISEN

NÜRNBERG

www.findeisen-watches.com

info@findeisen-uhren.com

facebook.com/findeisenuhren

[@findeisen_watches_official](#)